

## dimension

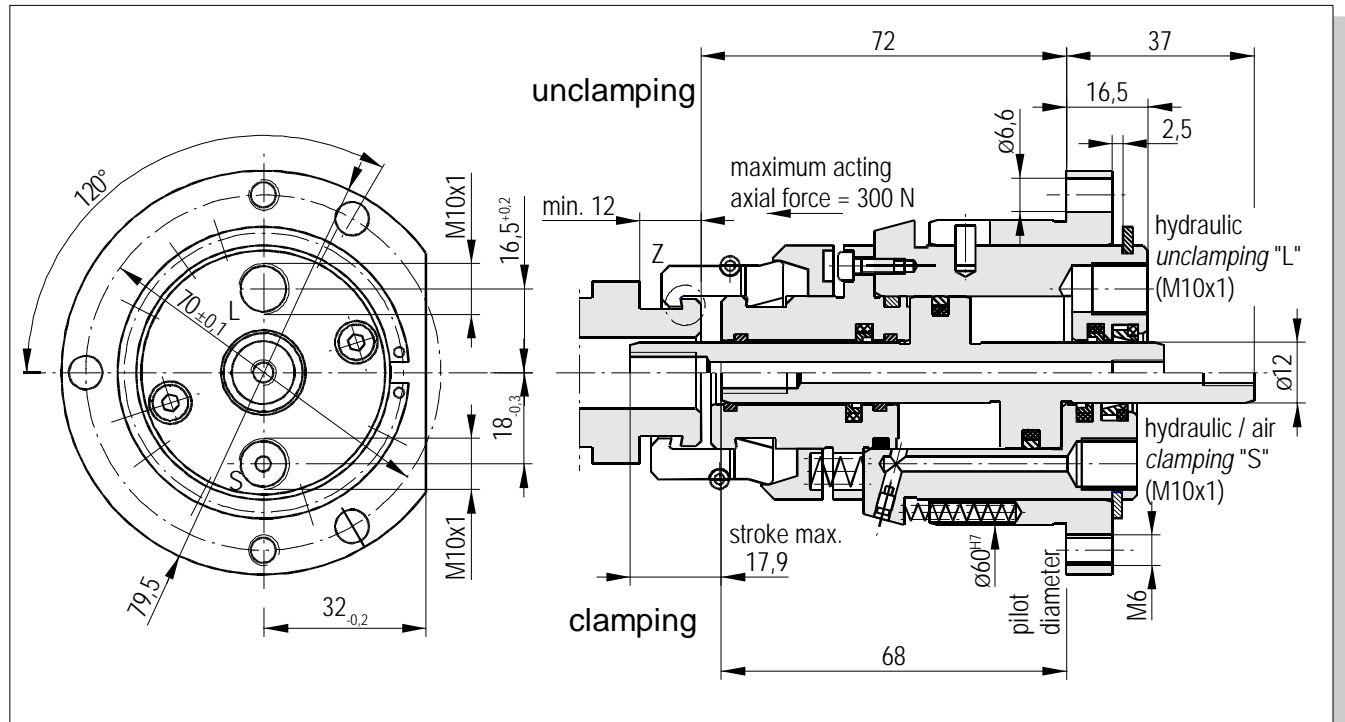

## gripper contour

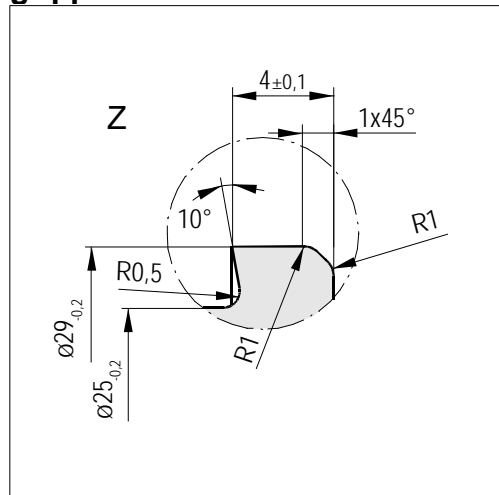

## technical data

piston area "L" .....	5,8	cm <sup>2</sup>
piston area "S" .....	5,8	cm <sup>2</sup>
hydraulic pressure "L" max.....	160	bar
hydraulic / air pressure "S" min.....	5	bar

## features

- passage for air cleaning in unclamped position
- low bearing load
- easy to assemble
- RPM independent

## code

0	2
---	---